

METRIC - NPT/METRIC

X	Z	H (MIN)	B (MAX)	L	T	D		W	BOX QTY
						ATEX	IEC		
M16	1/2"NPT	23	10.3	17	21	17	20	4	10
M16	M20	23	10.3	17	21	17	17	4	10
M20	3/4"NPT	30	14.3	17	21	17	20	4	10
M20	M25	30	14.3	17	21	17	17	4	10
M25	1"NPT	37	19.3	17	30	25	25	5	10
M25	M32	37	19.3	17	21	17	17	4	10
M32	1.1/4"NPT	47	25.8	17	30.5	25	25	5.5	10
M32	M40	47	25.8	17	21	17	17	5	10
M40	1.1/4"NPT	47	33.3	17	30.5	25	25	5.5	5
M40	1.1/2"NPT	55	33.3	17	22	26	26	6	5
M40	M50	55	33.3	17	30.5	17	17	5.5	5
M50	1.1/2"NPT	55	42.8	17	32	26	26	6	5
M50	2"NPT	85	42.8	17	22.5	27	27	6.5	5
M50	M63	70	42.8	17	32	17	17	6	5
M63	2"NPT	85	54.3	17	33.5	27	27	6.5	5
M63	2.1/2"NPT	95	54.3	17	23	35	35	7	5
M63	M75	80	54.3	17	23.5	17	17	6.5	5
M75	2.1/2"NPT	95	66.8	17	42	35	35	7	5
M75	3"NPT	105	66.8	17	43.5	35	35	8.5	5
M75	M80	90	66.8	17	24	17	17	7	5

MARKING DETAILS:

GROUP I - HAWKE 476/1A SIRA06ATEX1240U IM2 EExde I M20xM25

GROUP II - HAWKE 476/1A SIRA06ATEX1240U II2GD EExde IIC M20xM25

AN UNDERCUT TO THREAD ROOT DIAMETER MAY BE MACHINED FOR EExe OR WITH THE INSTALLERS UNDERSTANDING THAT THE MINIMUM THREAD ENGAGEMENT MUST STILL BE ACHIEVED.

HEXAGON MAY BE TURNED TO PRODUCE A MARKING SURFACE. LENGTH MAX 8mm TO A DIA OF A/F/ -1mm

NPT - METRIC/NPT

X	Z	H	B	L		T		D		W	BOX QTY
				ATEX	IEC	ATEX	IEC	ATEX	IEC		
1/2"	3/4" NPT	30	14.3	17	20	21	24.5	17	20	4	10
1/2"	M20	23	14.3	17	20	21	21	17	17	4	10
1/2"	M25	30	14.3	17	20	21	21	17	17	4	10
3/4"	1"NPT	37	19.1	17	20	22	30	17	25	5	10
3/4"	M25	30	19.1	17	20	21	21	17	17	4	10
3/4"	M32	37	19.1	17	20	22	22	17	17	5	10
1"	1.1/4"NPT	47	24.1	17	25	23.5	30.5	18	25	5.5	10
1"	M32	37	24.1	17	25	21	21	17	17	4	10
1"	M40	47	24.1	17	25	22	22	17	17	5	10
1.1/4"	1.1/2"NPT	55	32.9	18	25	24.5	32	18.5	26	6	5
1.1/4"	M40	47	32.9	18	25	22	22	17	17	5	5
1.1/4"	M50	55	32.9	18	25	22.5	22.5	17	17	5.5	5
1.1/2"	2"NPT	70	38.5	18.5	25	25.5	33.5	19	27	6.5	5
1.1/2"	M50	55	38.5	18.5	25	22.5	22.5	17	17	5.5	5
1.1/2"	M63	70	38.5	18.5	25	23	23	17	17	6	5
2"	2.1/2"NPT	85	50	19	25	36	42	29	35	7	5
2"	M63	70	50	19	25	23	23	17	17	6	5
2"	M75	80	50	19	25	23.5	23.5	17	17	6.5	5
2.1/2"	3"NPT	95	60	29	35	38.5	43	30.5	35	8	5
2.1/2"	M75	80	60	29	35	23.5	23.5	17	17	6.5	5

A3 THIS IS A CAD DRAWING AND MUST BE EDITED AT SOURCE

**HAWKE**  
International  
OXFORD ST WEST  
ASHTON-U-LYNE  
OL7 0NA  
TEL: +44 (0)161 308 3611

ALL COPYRIGHT RESERVED - HAWKE INTERNATIONAL 2005. THIS DRAWING AND ALL COPYRIGHT THEREIN IS THE PROPERTY OF HAWKE INTERNATIONAL, A DIVISION OF HUBBELL LIMITED. (A member of the Hubbell Group of Companies).



(COPYRIGHT CONDITION: THIS DRAWING SHALL BE USED ONLY FOR THE PURPOSE FOR WHICH IT IS PROVIDED AND NO REPRODUCTION OR PUBLICATION OF THIS DRAWING MAY BE MADE AND NO ARTICLE MAY BE MANUFACTURED OR ASSEMBLED IN ACCORDANCE WITH THIS DRAWING WITHOUT THE PRIOR WRITTEN CONSENT OF THE OWNER.

GENERAL TOLERANCES  
LINEAR ± 0.15mm  
ANGULAR ± 0°30'

REMOVE ALL BURRS AND SHARP EDGES USING MINIMUM CHAMFER OR RADIUS. PARTICULARLY REMOVE ALL BURRS FROM START AND FINISH OF THREADS

UNLESS OTHERWISE STATED

DRN	DMJ				
CHD	AJT				
DATE	03/04/07				
UNITS	mm				
FIRST ISSUE		XXXXXX	HCG06/XXX	A	
MODIFICATION		DATE/SIG	DCN	ISSUE	

TITLE  
**HAWKE - 476/1A**

DRG. No.  
**476/1A**  
SCALE NTS SHEET 1 OF 1

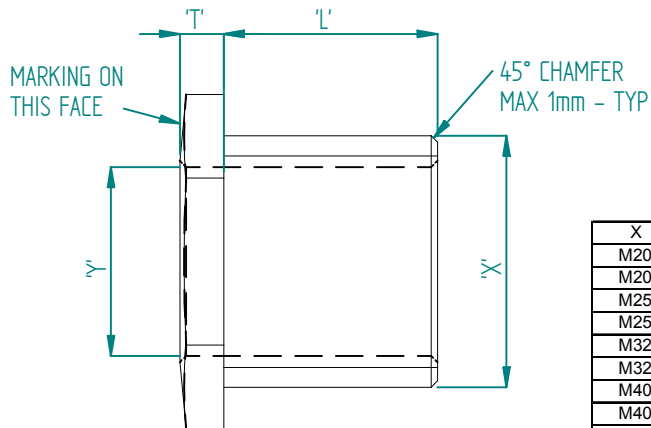
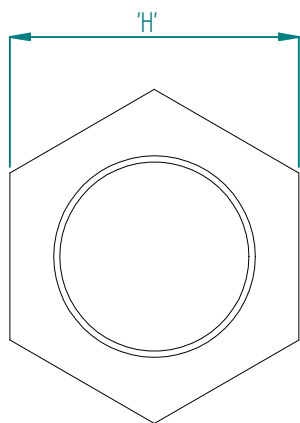

METRIC MALE

X	OPTIONAL SIZES Y	H	L MIN	T	BOX QTY
M20	1/4", 1/8" NPT	23	17	3.5	10
M20	M16	23	17	3.5	10
M25	1/2", 3/8", 1/4", 1/8" NPT	27.5	17	3.75	10
M25	M20, M16	27.5	17	3.75	10
M32	3/4", 1/2", 3/8", 1/4", 1/8" NPT	37.5	17	4	10
M32	M25, M20, M16	37.5	17	4	10
M40	1", 3/4", 1/2", 3/8", 1/4", 1/8" NPT	47	17	4.5	5
M40	M32, M25, M20, M16	47	17	4.5	5
M50	1.1/4", 1", 3/4", 1/2", 3/8", 1/4", 1/8" NPT	55	17	5	5
M50	M40, M32, M25, M20, M16	55	17	5	5
M63	1.1/2", 1.1/4", 1", 3/4", 1/2", 3/8", 1/4", 1/8" NPT	70	17	6	5
M63	M50, M40, M32, M25, M20, M16	70	17	6	5
M75	2", 1.1/2", 1.1/4", 1", 3/4", 1/2", 3/8", 1/4", 1/8" NPT	80	17	7	5
M75	M63, M50, M40, M32, M25, M20, M16	80	17	7	5

NOTE: PRODUCT MAY BE MARKED WITH ATEX OR IECEX

MARKING: ATEX

GROUP I - HAWKE 476/1 SIRA06ATEX1240U IM2 EExde I M32xM25

GROUP II - HAWKE 476/1 SIRA06ATEX1240U II2GD EExde IIC M32xM25

MARKING: IECEX

GROUP I - HAWKE 476/1 IECEX SIR.07.0037X IM2 Exde I M32xM25

GROUP II - HAWKE 476/1 IECEX SIR.07.0037X II2GD Exde IIC M32xM25

AN UNDERCUT TO THREAD ROOT DIAMETER  
MAY BE MACHINED FOR EExe OR WITH  
THE INSTALLERS UNDERSTANDING THAT  
THE MINIMUM THREAD ENGAGEMENT  
MUST STILL BE ACHIEVED.

NPT MALE

X	Y	H	ATEX(L)	T	BOX QTY
1/2"NPT	3/8", 1/4", 1/8" NPT	23	17	3.5	10
1/2"NPT	M16	23	17	3.5	10
3/4"NPT	1/2", 3/8", 1/4", 1/8" NPT	23	17	3.75	10
3/4"NPT	M20, M16	27.5	17	3.75	10
1"NPT	3/4", 1/2", 3/8", 1/4", 1/8" NPT	37.5	17	4	10
1"NPT	M25, M20, M16	37.5	17	4	10
1.1/4"NPT	1", 3/4", 1/2", 3/8", 1/4", 1/8" NPT	50	18	4.5	5
1.1/4"NPT	M32, M25, M20, M16	50	18	4.5	5
1.1/2"NPT	1.1/4", 1", 3/4", 1/2", 3/8", 1/4", 1/8" NPT	55	18.5	5	5
1.1/2"NPT	M40, M32, M25, M20, M16	55	18.5	5	5
2"NPT	1.1/2", 1.1/4", 1", 3/4", 1/2", 3/8", 1/4", 1/8" NPT	70	19	6	5
2"NPT	M50, M40, M32, M25, M20, M16	70	19	6	5
2.1/2"NPT	2", 1.1/2", 1.1/4", 1", 3/4", 1/2", 3/8", 1/4", 1/8" NPT	85	29	6.5	5
2.1/2"NPT	M63, M50, M40, M32, M25, M20, M16	85	29	6.5	5
3"NPT	2.1/2", 2", 1.1/2", 1.1/4", 1", 3/4", 1/2", 3/8", 1/4", 1/8" NPT	95	30.5	8	5
3"NPT	M75, M63, M50, M40, M32, M25, M20, M16	95	30.5	8	5

A3 THIS IS A CAD DRAWING AND MUST BE EDITED AT SOURCE

**HAWKE**  
International  
OXFORD ST WEST  
ASHTON-U-LYNE  
QL7 0NA  
TEL: +44 (0)161 308 3611

ALL COPYRIGHT RESERVED - HAWKE INTERNATIONAL 2005  
THIS DRAWING AND ALL COPYRIGHT THEREIN IS THE PROPERTY  
OF HAWKE INTERNATIONAL, A DIVISION OF HUBBELL LIMITED.  
(A member of the Hubbell Group of Companies).



(COPYRIGHT CONDITION: THIS DRAWING SHALL BE USED ONLY FOR THE PURPOSE  
FOR WHICH IT IS PROVIDED AND NO REPRODUCTION OR PUBLICATION OF THIS  
DRAWING MAY BE MADE AND NO ARTICLE MAY BE MANUFACTURED OR  
ASSEMBLED IN ACCORDANCE WITH THIS DRAWING WITHOUT THE PRIOR WRITTEN  
CONSENT OF THE OWNER.

REMOVE ALL BURRS AND SHARP EDGES USING MINIMUM CHAMFER OR RADIUS  
PARTICULARLY REMOVE ALL BURRS FROM START AND FINISH OF THREADS

3RD ANGLE PROJECTION

DO NOT SCALE IF IN DOUBT ASK

GENERAL TOLERANCES

LINEAR ± 0.15mm  
ANGULAR ± 0°30'

UNLESS OTHERWISE STATED

MALE M75 METRIC DEATILS ADDED	AJT 22/1/09	HCG09/ 003	C	DRN	DMJ	TITLE
IECEX CERTIFICATION ADDED	20/3/08	HCG09/ 007	B	CHD	AJT	<b>HAWKE - 476/1</b>
FIRST ISSUE	xxx/xx/xx	HCG09/ xxx	A	DATE	03/04/07	
MODIFICATION	DATE/SIG	DCN	ISSUE	UNITS	mm	DRG. No.

DRG. No.	476/1
SCALE	NTS
SHEET	1 OF 1